

PARTNERS



PDI Design

Founded in 1994, PDI Design specializes in interior consultancy, construction, and renovation. Handling diverse projects, PDI serves 50 million people across 20 million square feet with high-quality finishes and customer satisfaction. Now, integrating advanced technologies, PDI creates smarter, more efficient, and luxurious spaces, enhancing convenience, security, and energy efficiency. This innovation positions PDI at the forefront of the design industry, meeting modern needs with unparalleled comfort and sophistication.



Signature Kitchen

Signature is an end-to-end solution provider for your home. From 3D design proposals to renovation and installation, from interior design service to interior fittings, and from custom built-in furniture to home appliances, Signature will bring your dream home to life.



DBI floor

is a leading SRC flooring specialist in Malaysia that offers a range of excellent flooring solutions in Malaysia. We are committed to delivering exceptional flooring solutions for you!



Saint-Gobain | Prima | Gyproc

Saint-Gobain is a worldwide leader in light and sustainable construction. Saint-Gobain designs, manufactures and distributes materials and services for the construction and industrial markets. Its integrated solutions for the renovation of public and private buildings, light construction and the decarbonization of construction and industry are developed through a continuous innovation process and provide sustainability and performance.

The Group's commitment is guided by its purpose, "MAKING THE WORLD A BETTER HOME".



Clayton

Clayton Group manufactures and supplies the highest quality bathroomware and ceramicware. They aim to create a living space that's harmony with the natural systems that sustaining all life, using earth's resources sustainably and to meet current needs without compromising the well-being of future generations.



Laser Ceram

A reputable supplier specializing in metal stamping, sheet metal fabrication, metal finishing, mechanical assemblies, furniture hardware trading, product design & development.



Le Nam Megashield | BlueScope

Leading local manufacturers of metal roofing and steel products.



Premier Channel

Malaysia's leading provider of soft furnishings, including wallpaper, vinyl flooring, artificial grass, wall boards, and high-grade carpets, for both residential and commercial projects. They also provide comprehensive installation services from start to finish. Whether you're redecorating a cozy home or outfitting a large commercial property, their team of skilled professionals is dedicated to delivering exceptional results.



Chong Wah Construction

Specializes in renovation and construction, including windows, doors, cabinets, partitions, ceilings, and more.

Envi-Cel 365

ENVICEL - Keeps you comfortable (Hot or Cold), this advance composite energy optimization system uses recycled plastics (PET) and blend "proprietary" technology to shield you from heat and stop harmful fungi and bacteria growth, giving you a piece of microclimating in a comfortable and healthy environment.

Top Spengler

A plumbing supply store, offering a wide range of high-quality plumbing products and solutions.

Sayushii Electrical

An experience manufacturer, trader, and supplier of all sorts electrical goods.

AFFORDABLE COMEL

Size : 3m x 6m x 2.6m (H)

AC 1
200 sqft



AC 2
200 sqft

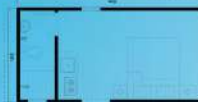

MAIN STRUCTURE	VE Engineer Steel Structure	FLOORING	Vinyl Flooring Material
INTERNAL WALL	Deco PVC Panel Material	CEILING	PVC Panel Material
EXTERNAL WALL	Metal Decking Material	OTHER ITEMS	Single Piece WC, Wash Basin, Bidet, Shower Head, Basic Kitchen Sink, Aluminium Glass Door, Casement Windows, 13A Plug Points, 15A Air Conditioning Points, Water Heater Point, DB Box

CONTACT US



WHATSAPP
019 698 8855



FACEBOOK
facebook.com/rumahcomelbysh

🌐 www.rumahcomel.my

✉ rumahcomel@solidhorizon.com

📍 Lot 4912, Jalan Teratai 5 1/2 Miles Off,
Jalan Meru, 41050 Klang, Selangor



RUMAH COMEL 3.0

Smart Tiny, Affordable Comel



Visit us at Booth, 4D408 in Hall 4



At Rumah Comel, we prioritize ESG. With ISO certifications in (QHSE), environmental and quality management, we continuously strive for sustainability while delivering prestigious quality to the public.



About Rumah Comel

After the successes of Rumah Comel 1.0 & 2.0, this year introduces an enhanced version, with the slogan 'Smart Tiny, Affordable Comel', tailored to diverse needs. The concept behind RUMAH COMEL revolves around the notion of deriving satisfaction from owning only essential items and rediscovering the true essence of living. This prefab tiny house serves multiple purposes, functioning as a primary residence, guest house, or versatile multipurpose room, with the vision of making homeownership accessible to everyone without the burden of high costs.

SMART TINY

Size: 3m x 6m x 3m (H)

Type A
300 sqft

Type B
300 sqft

Type D
400 sqft

Type E
400 sqft

Type C
400 sqft

Type F
400 sqft

MAIN STRUCTURE	Steel Structure	EXTERNAL WALL	Premium Deck / Cement Board
BATHROOM WALL	SPC Material	CEILING	Plasterboard Ceiling / PVC Panel
WALL INSULATION	Rockwool Insulation	INTERIOR WALL	Gypsum Board with Decor Panel
INTERNAL FLOORING	SPC Material	OTHER ITEMS	Single Piece WC, Wash Basin, Bidet, Shower Head, Basic Kitchen Sink, Akurni, Glass Door, Casement, Windows, 13A Plug Points, 15A Air Conditioning Points, Water Heater Point, DB Box
TOILET FLOORING	SPC Material		

Simple Lifestyle

Minimal Electricity Consumption

High Mobility

Smaller Size, Reduced Living Costs

Low Maintenance

Integrated Smart Home Systems

- Automated Lighting Control
- Security Systems (Cameras, Alarms & Smart Locks)
- Voice Control Home Automation
- Energy Usage Monitoring
- Sensors (Motion, Door/Window, Temperature & Water Leakage)

www.rumahcomel.my |
 rumahcomel@solidhorizon.com |
 019-698 8855